



# Technical Data Sheet M-PS 102

GVT.

2/2-way solenoid valve - valve normally closed (NC)  
- valve normally open (NO)

## Solenoid valve for liquid and gaseous media

- For low pressure applications
- No pressure difference necessary
- High life time
- Reliable and sturdy sealing elements
- Long-term availability of spare parts
- High-quality materials

## TECHNICAL SPECIFICATIONS

Type of control:	Direct operated, no pressure difference necessary
Design:	Poppet design
Connection:	Threaded Rp 3/8 - Rp 3 DIN ISO 2999 (BSP) <i>Further connections on request</i>
Installation:	Actuator upright
Pressure:	1 - 5 bar (see table page 2)
Medium:	Clean, neutral, liquid or gaseous
Viscosity:	22 mm <sup>2</sup> /s
Temperature range:	Medium: -40 °C up to +80 °C Ambient: -40 °C up to +50 °C
Body material	Brass 2.0402 Stainless steel 1.4581 (AISI 316Ti)
Metallic inner parts:	Brass and Stainless steel
Sealing:	NBR, FKM, PTFE, EPDM

Supply voltage:	AC 50/60Hz 24V, 110V, 230V DC 0Hz 12V, 24V
Voltage tolerance:	-10% / +10%
Consumption:	A03 = 18 Watt      E02 = 10 Watt A05 = 24 Watt      E05 = 24 Watt A06 = 30 Watt      E06 = 24 Watt A07 = 46 Watt      E07 = 30 Watt A08 = 100 Watt     E08 = 47 Watt A09 = 352 Watt     E09 = 75 Watt
Protection class:	IP 65 acc. to DIN 60529
Duty factor:	100% ED - VDE 0580
Connection type:	Plug / Terminal box
Funktion:	<div style="display: flex; justify-content: space-around;"> <div style="text-align: center;"> <p>NC</p> </div> <div style="text-align: center;"> <p>NO</p> </div> </div>

Certificates:

Ex-proof: acc. to directive 2014/34/EG (ATEX)

## ORDERING SYSTEM

<b>M-PS</b>	<b>1</b>	<b>02</b>	<b>G</b>	<b>D</b>	<b>13.0</b>	<b>B</b>	<b>A</b>	<b>A06</b>	<b>NO</b>
Type	Control type	Code	Connection type	Connection size	Nominal diameter mm	Body material	Sealing material	Actuator type	Option
	1 direct operat.		G BSP N NPT	C 3/8 D 1/2 E 3/4 F 1 G 1 1/4 H 1 1/2 I 2 P 2 1/2 Q 3		B Brass C AISI316	A NBR B FKM C EPDM D PTFE	A standard E ex-proof	

Standard NC type	Seat $\phi$ mm	Kv-value $\text{m}^3/\text{h}$	max. pressure					
			A03	A05	A06	A07	A08	A09
M-PS 102 GC	8	1.2	0-3	0-5	-	-	-	-
M-PS 102 GC	10	2.1	0-2	0-3	-	-	-	-
M-PS 102 GD	8	1.2	0-3	0-5	-	-	-	-
M-PS 102 GD	10	2.1	0-2	0-3	-	-	-	-
M-PS 102 GD	13	3.2	-	0-1	0-2	0-5	-	-
M-PS 102 GE	18	4.9	-	0-0.5	0-1	0-2.5	0-5	-
M-PS 102 GF	24	8.5	-	0-0.3	0-0.5	0-1	0-1.6	-
M-PS 102 GG	29	15.0	-	-	0-0.3	0-0.6	0-1	-
M-PS 102 GH	35	20.0	-	-	0-0.1	0-0.3	0-0.5	0-0.8
M-PS 102 GI	45	30.0	-	-	-	0-0.15	0-0.4	0-1
M-PS 102 GP	62	58.0	-	-	-	-	0-0.15	0-0.4
M-PS 102 GQ	75	60.0	-	-	-	-	0-0.1	0-0.3

Standard NC type	Seat $\phi$ mm	Kv-value $\text{m}^3/\text{h}$	max. pressure with ATEX coils					
			E02	E05	E06	E07	E08	E09
M-PS 102 GC	8	1.2	0-1	0-5	-	-	-	-
M-PS 102 GC	10	2.1	0-0.5	0-3	-	-	-	-
M-PS 102 GD	8	1.2	0-1	0-5	-	-	-	-
M-PS 102 GD	10	2.1	0-0.5	0-3	-	-	-	-
M-PS 102 GD	13	3.2	-	0-1	-	-	-	-
M-PS 102 GE	18	4.9	-	0-0.5	0-0.8	-	-	-
M-PS 102 GF	24	8.5	-	0-0.3	0-0.5	0-0.7	0-1	-
M-PS 102 GG	29	15.0	-	-	0-0.1	0-0.3	0-0.8	-
M-PS 102 GH	35	20.0	-	-	-	0-0.2	0-0.3	-
M-PS 102 GI	45	30.0	-	-	-	-	0-0.2	0-0.35
M-PS 102 GP	62	58.0	-	-	-	-	-	0-0.15
M-PS 102 GQ	75	60.0	-	-	-	-	-	0-0.1

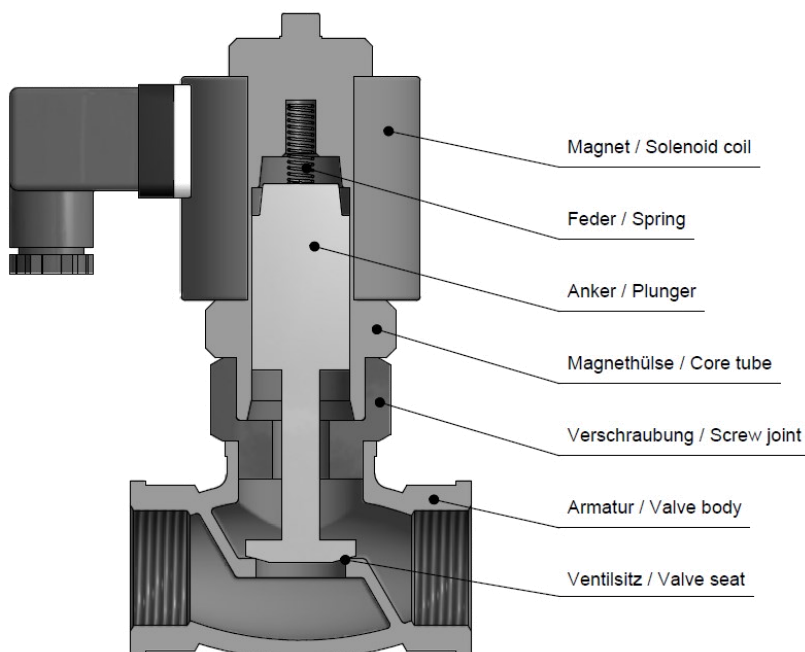

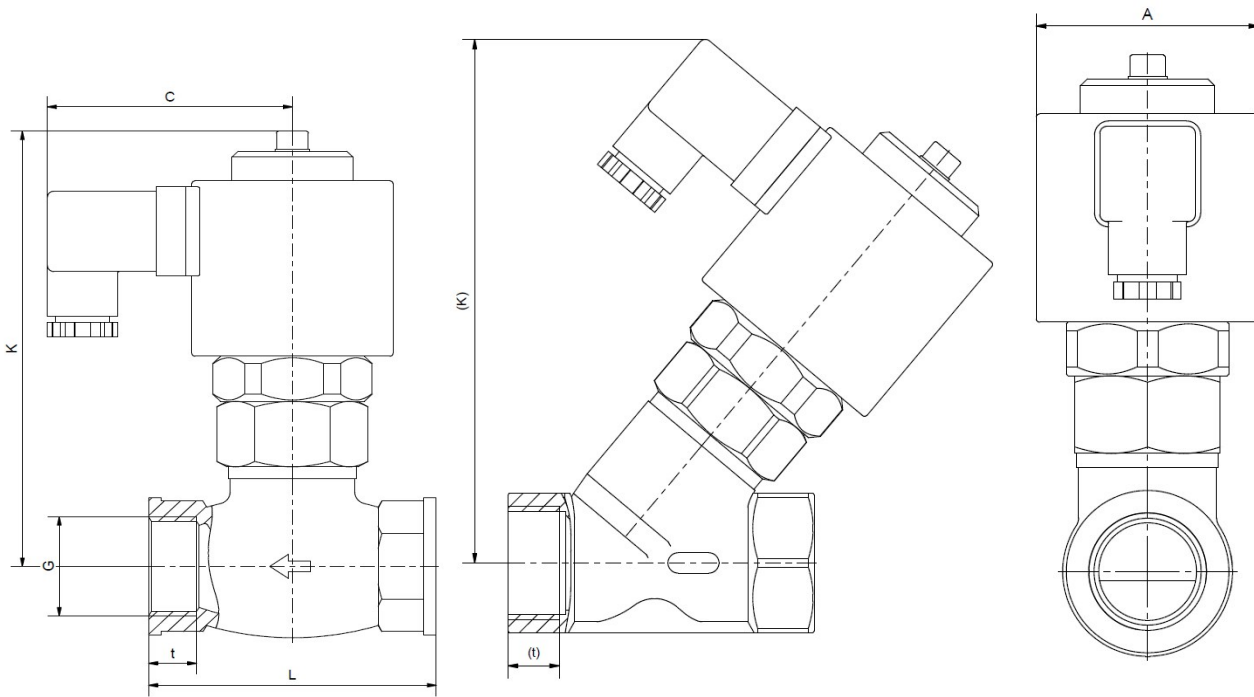

Coil	A03 / E02			A05 / E05			A06 / E06				
Type	M-PS 102 GC	M-PS 102 GD	M-PS 102 GC	M-PS 102 GD	M-PS 102 GE	M-PS 102 GF	M-PS 102 GD	M-PS 102 GE	M-PS 102 GF	M-PS 102 GG	M-PS 102 GH
G	3/8	1/2	3/8	1/2	3/4	1	1/2	3/4	1	1 1/4	1 1/2
A	36	36	50	50	50	50	63	63	63	63	
C	61	61	70	70	70	70	77	77	77	77	77
K	75	75	92	107 (125)	113 (129)	117 (133)	137 (145)	139 (152)	147 (154)	149 (160)	144 (164)
L	54	54	54	65	75	90	65	75	90	110	120
t	10	10	10	11 (12)	12 (13)	14 (15)	11 (12)	12 (13)	14 (15)	16 (17)	18 (19)
kg	0.6	0.6	1.0	1.1	1.2	1.5	2.0	2.0	2.3	2.6	3.0

Values in brackets apply to the stainless steel angle seat version  
Differing dimension „C“ for ATEX-coils

Coil	A07 / E07						A08 / E08				
Type	M-PS 102 GE	M-PS 102 GF	M-PS 102 GG	M-PS 102 GH	M-PS 102 GI	M-PS 102 GF	M-PS 102 GG	M-PS 102 GH	M-PS 102 GI	M-PS 102 GP	M-PS 102 GQ
G	3/4	1	1 1/4	1 1/2	2	1	1 1/4	1 1/2	2	2 1/2	3
A	77	77	77	77	77	105	105	105	105	105	105
C	93	93	93	93	93	107	107	107	107	107	107
K	166 (179)	165 (184)	170 (192)	180 (190)	178 (203)	197 (207)	200 (210)	203 (231)	211 (225)	217	223
L	75	90	110	120	150	90	110	120	150	175	200
t	12 (13)	14 (15)	16 (17)	18 (19)	20 (21)	14 (15)	16 (17)	18 (19)	20 (21)	19	22
kg	3.4 (3.5)	4.0 (3.7)	4.2 (4.3)	4.6 (4.5)	5.3 (5.7)	7.7 (7.8)	7.8 (8.2)	8.3 (8.8)	9.1 (9.8)	10.6	12.9

Values in brackets apply to the stainless steel angle seat version  
Differing dimension „C“ for ATEX-coils

- The GVT logo is a registered trademark.
- Note: All texts and images are the property of GVT and must not be replicated or modified, not even in part, without written approval.
- Original products may differ from the product images shown, due to different materials and the like.
- Subject to error and changes.