





- 2/2-Way pressure controlled valve - valve normally closed (NC)
- valve normally open (NO)
- double acting actuator (DW)

Pressure controlled valve for high temperature applications

- For high temperature up to **+300 °C**
- No pressure difference necessary
- High life time
- Reliable and sturdy sealing elements
- Long-term availability of spare parts
- High-quality materials

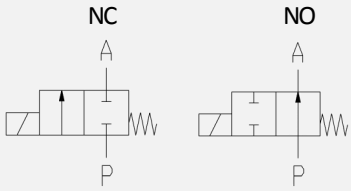
TECHNICAL SPECIFICATIONS

Type of control:	Direct acting, pressure controlled	Supply voltage:	-
Design:	Poppet design	Voltage tolerance:	-
Connection:	Threaded G 1/2 - G 3 DIN ISO 228 (BSP) Further connections like NPT on request	Consumption:	-
Installation:	Actuator preferable upright	Protection class:	-
Pressure:	0-40 bar (see table page 2)	Duty factor:	-
Medium:	Clean, neutral, gaseous and liquid	Connection type:	-
Viscosity:	600 mm ² /s	Function:	
Temperature range:	Medium: -40 °C up to +300 °C Ambient: -40 °C up to +60 °C	Certificates:	
Body material	Red brass RG5 Stainless steel 1.4408 (AISI 316L)	Ex-proof:	optional with mech. ATEX
Metallic inner parts:	Brass and Stainless steel		
Sealing:	PEEK, metallic		
Pilot pressure:	4-10 bar		
Pilot medium:	clean and neutral gases		

ORDERING SYSTEM

P-ET	1	01	G	D	13.5	H	E	P05	NO
Type	Control type	Code	Connection type	Connection size	Nominal diameter mm	Body material	Sealing material	Actuator type	Option
	1 direct acting		G BSP N NPT	D 1/2 E 3/4 F 1 G 1 1/4 H 1 1/2 I 2 P 2 1/2 Q 3		D AISI316L H Red brass	E PEEK G Metal	05 50 mm 08 80 mm 13 125 mm	

Standard NC type	Seat ϕ mm	Kv-value m ³ /h	max. pressure with actuator					
			P05		P08		P13	
			RG5	AISI316	RG5	AISI316	RG5	AISI316
P-ET 101 GD	13	4.6	0-16	0-40	-	-	-	-
P-ET 101 GE	18	6.4	0-16	0-20	-	0-40	-	-
P-ET 101 GF	24	8.4	0-16	0-16	0-16	0-25	-	0-40
P-ET 101 GG	31	21.5	0-10	0-10	0-16	0-25	-	0-40
P-ET 101 GH	35	27.0	0-7	0-7	0-16	0-20	0-16	0-40
P-ET 101 GI	45	45.0	-	-	0-12	0-12	0-16	0-25
P-ET 101 GP	63	82.0	-	-	-	-	0-10	-
P-ET 101 GQ	75	125.0	-	-	-	-	0-10	-

Standard NC type	Seat ϕ mm	Kv-value m ³ /h	max. pressure for closing against media design					
			P05		P08		P13	
			RG5	AISI316	RG5	AISI316	RG5	AISI316
P-ET 101 GD	13	4.6	0-16	0-40	-	-	-	-
P-ET 101 GE	18	6.4	0-16	0-20	-	0-40	-	-
P-ET 101 GF	24	8.4	0-10	0-10	0-16	0-22	-	0-40
P-ET 101 GG	31	21.5	0-7	0-7	0-10	0-10	0-16	0-40
P-ET 101 GH	35	27.0	0-6	0-6	0-8	0-8	0-16	0-30
P-ET 101 GI	45	45.0	-	-	0-5	0-5	0-16	0-20
P-ET 101 GP	63	82.0	-	-	-	-	0-8.5	-
P-ET 101 GQ	75	125.0	-	-	-	-	0-5	-

Valve design

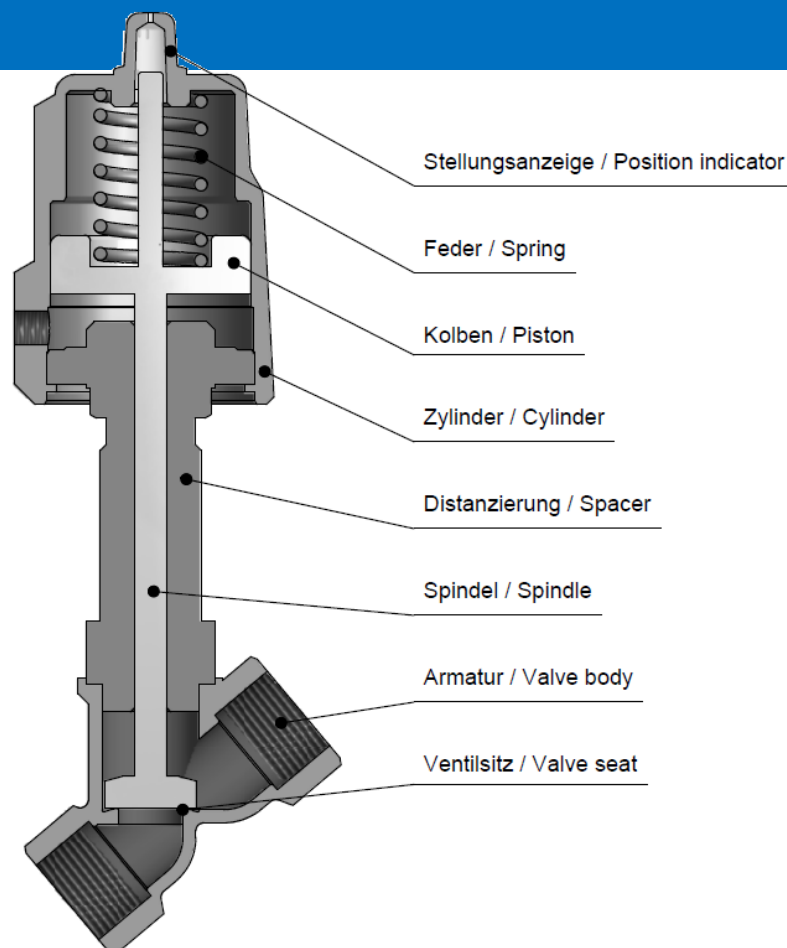

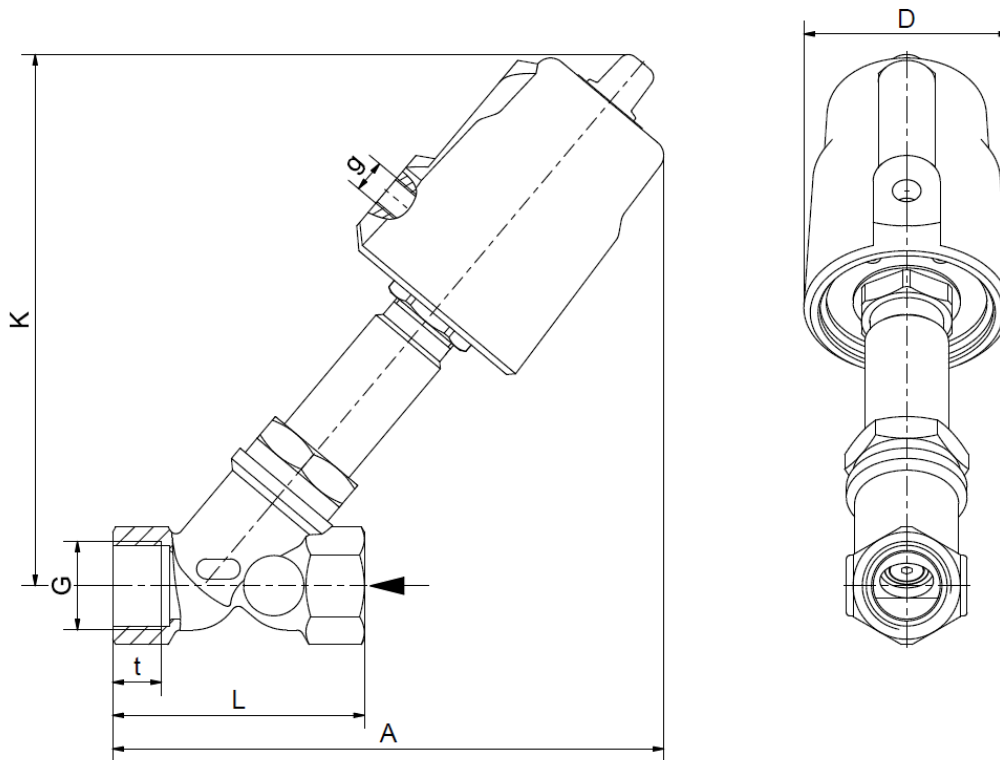

Actuator Type	P05					P08			
	P-ET 101					P-ET 101			
	GD	GE	GF	GG	GH	GF	GG	GH	GI
G	1/2	3/4	1	1 1/4	1 1/2	1	1 1/4	1 1/2	2
A	158	165	170	188 (190)	200	208	217	224	235
D	62	62	62	62	62	94	94	94	94
K	158	161	164	180	187	208	217	218	229
L	65	75	90	97 (110)	120	80	97	107	124
g	1/8	1/8	1/8	1/8	1/8	1/8	1/8	1/8	1/8
kg	1.4	1.5	1.9	2.4	2.7	2.0	2.5	2.9	3.2

Values in brackets applies to the stainless steel version

Actuator Type	P13					
	P-ET 101					
	GF	GG	GH	GI	GP	GQ
G	1	1 1/4	1 1/2	2	2 1/2	3
A	on req.	275	280	385	330	350
D	140	140	140	140	140	140
K	on req.	275	280	285	300	305
L	80	110	107	124	178	195
g	1/4	1/4	1/4	1/4	1/4	1/4
kg	on req.	5.0	5.5	6.5	8.0	9.5

Values in brackets applies to the stainless steel version

- The **GVT** logo is a registered trademark.
- Note: All texts and images are the property of **GVT** and must not be replicated or modified, not even in part, without written approval.
- Original products may differ from the product images shown, due to different materials and the like.
- Subject to error and changes.