

2/2-way solenoid valve - valve normally closed (NC)  
- valve normally open (NO)



## Solenoid valve for neutral, gaseous and liquid media

- For general purposes
- No pressure difference necessary
- High life time
- Reliable and sturdy sealing elements
- Long-term availability of spare parts
- High-quality materials

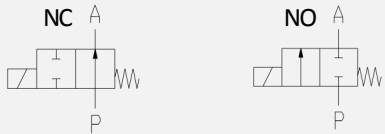

## TECHNICAL SPECIFICATIONS

Type of control:	Force-pilot operated, no pressure difference necessary
Design:	Diaphragm design
Connection:	Flanged acc. to EN 1092-1 Form B1/B2 <i>Further connections on request</i>
Installation:	Actuator upright
Pressure:	0 - 16 bar (see table page 2)
Medium:	Clean, neutral, liquid or gaseous
Viscosity:	22 mm <sup>2</sup> /s
Temperature range:	Medium: -10 °C up to +80 °C Ambient: -10 °C up to +50 °C
Body material	Cast Iron EN-GJL-250 (DN20-DN150) Cast steel GP240 GH (DN15-DN100) Spheroidal cast EN-GJS-400-18-LT (DN150) Stainless steel 1.4581 (DN15-DN50)
Metallic inner parts:	Brass and stainless steel
Sealing:	NBR, FKM, EPDM

Supply voltage:	AC 50/60Hz 24V, 110V, 230V DC 0Hz 12V, 24V
Voltage tolerance:	-10% / +10%
Consumption:	A02 = 11 Watt E02 = 10 Watt A03 = 18,5 Watt A04 = 25 Watt E05 = 24 Watt A06 = 30 Watt E06 = 24 Watt A07 = 46 Watt E07 = 30 Watt A08 = 100 Watt E08 = 47 Watt
Protection class:	IP 65 acc. to DIN 60529
Duty factor:	100% ED - VDE 0580
Connection type:	Terminal box
Function:	
Certificates:	
Ex-proof:	acc. to directive 2014/34/EG (ATEX)

## ORDERING SYSTEM

M-DS	3	02	D	L	25.0	E	A	A04	HA
Type	Control type	Code	Connection type	Connection size	Nominal diameter mm	Body material	Sealing material	Actuator type	Option
	3 force-pilot oper.		D PN16 X PN40 A ANSI150 Y ANSI300	J DN15 K DN20 L DN25 M DN32 N DN40 O DN50 Q DN80 R DN100 T DN150		C AISI316L E EN-GJL-250 F GP240 GH G EN-GJS-400-18-LT	A NBR B FKM C EPDM	A standard E ex-proof	

Standard NC type	Seat ø mm	Kv-value m <sup>3</sup> /h	max. pressure					
			A02	A03	A04	A06	A07	A08
M-DS 302 DJ	15	3.9	0-10	0-16	0-16	-	-	-
M-DS 302 DK	20	10.8	0-6	0-10	0-16	-	-	-
M-DS 302 DL	25	13.0	0-6	0-10	0-16	-	-	-
M-DS 302 DM	32	30.0	-	-	-	0-10	0-16	0-16
M-DS 302 DN	40	32.0	-	-	-	0-10	0-16	0-16
M-DS 302 DO	50	45.0	-	-	-	0-6	0-16	0-16
M-DS 302 DQ	80	97.0	-	-	-	-	0-2	0-3
M-DS 302 DR	100	143.0	-	-	-	-	-	0-2
M-DS 302 DT	150	370.0	-	-	-	-	-	0-2

Standard NC type	Seat ø mm	Kv-value m <sup>3</sup> /h	max. pressure ATEX				
			E02	E05	E06	E07	E08
M-DS 302 DJ	15	3.9	0-8	0-16	-	-	-
M-DS 302 DK	20	10.8	0-5	0-16	-	-	-
M-DS 302 DL	25	13.0	0-5	0-16	-	-	-
M-DS 302 DM	32	30.0	-	-	0-3	0-10	0-16
M-DS 302 DN	40	32.0	-	-	0-3	0-6	0-16
M-DS 302 DO	50	45.0	-	-	0-3	0-6	0-16
M-DS 302 DQ	80	97.0	-	-	-	-	0-2
M-DS 302 DR	100	143.0	-	-	-	-	-
M-DS 302 DT	150	370.0	-	-	-	-	-

## Valve design

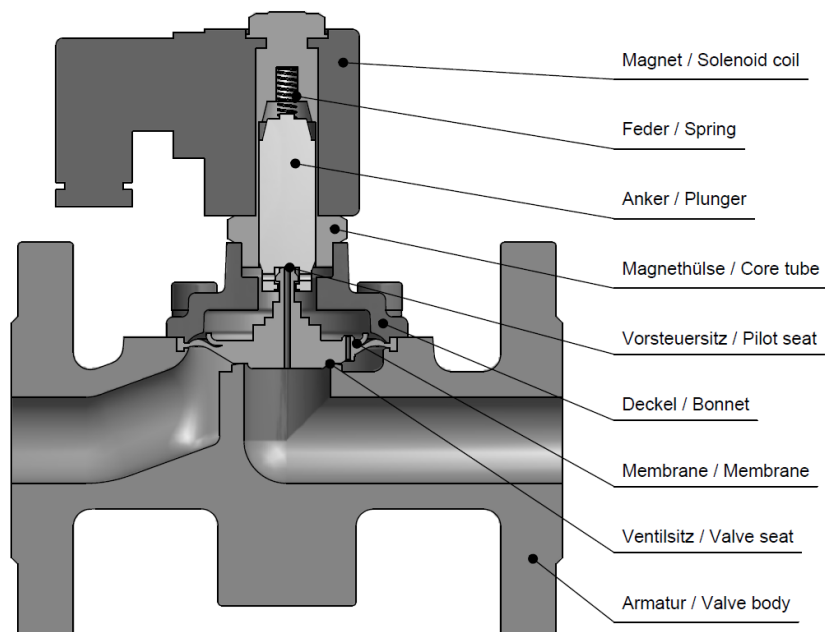

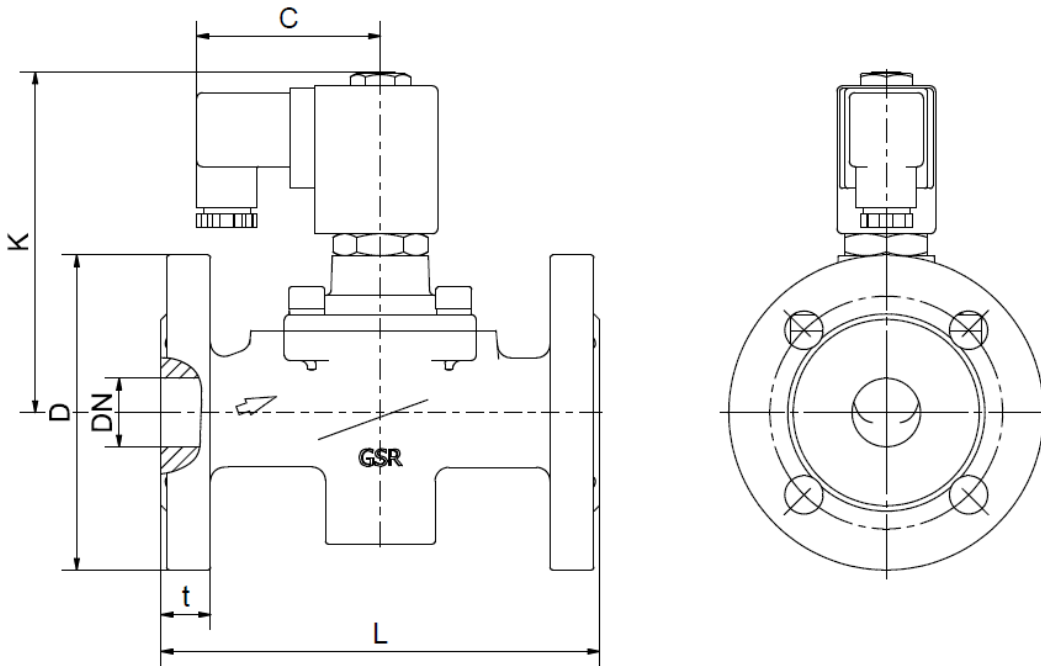

Coil	A02 / A03 / E02*			A04 / E05			A06 / E06		
Type	M-DS 302			M-DS 302			M-DS 302		
	DJ	DK	DL	DJ	DK	DL	DM	DN	DO
DN	15	20	25	15	20	25	32	40	50
C	61	61	61	67	67	67	77	77	77
D	95	105	115	95	105	115	140	150	165
K	94 (86)	100 (96)	100 (96)	114 (106)	127 (122)	127 (122)	184 (172)	184 (172)	192 (179)
L	130	150	160	130	150	160	180	200	230
t	16	18	18	16	18	18	18	18	20
kg	2.8	3.9	4.5	3.1	4.2	4.8	8.8	9.3	12.1

\* Different dimension „C“ for ATEX coils

Coil	A07 / E07				A08 / E08				
Type	M-DS 302				M-DS 302				
	DM	DN	DO	DQ	DM	DN	DO	DR	DT
DN	32	40	50	80	32	40	50	100	150
C	93	93	93	93	107	107	107	107	107
D	140	150	165	200	140	150	165	220	285
K	209 (198)	209 (198)	218 (205)	255	254 (242)	254 (242)	264 (251)	305	410
L	180	200	230	310	180	200	230	350	480
t	18	18	20	21	18	18	20	24	28
kg	9.7	10.2	13.0	29.0	13.7	14.3	17.3	46.5	86.0

\* Different dimension „C“ for ATEX coils

- The GVT logo is a registered trademark.
- Note: All texts and images are the property of GVT and must not be replicated or modified, not even in part, without written approval.
- Original products may differ from the product images shown, due to different materials and the like.
- Subject to error and changes.