





2/2-way solenoid valve - valve normally closed (NC)  
- valve normally open (NO)

## Solenoid valve for high temperature applications

- For high temperature applications **+140°C**
- Pressure difference necessary
- High life time
- Reliable and sturdy sealing elements
- Long-term availability of spare parts
- High-quality materials

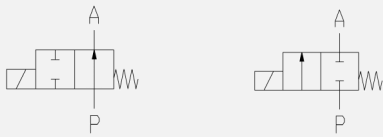
## TECHNICAL SPECIFICATIONS

Type of control:	Pilot operated, Pressure difference is required	Supply voltage:	AC 50/60Hz 24V, 110V, 230V DC 0Hz 12V, 24V
Design:	Diaphragm design	Voltage tolerance:	-10% / +10%
Connection:	Threaded G 1/4 - G 2 DIN ISO 228 (BSP) <i>Further connections on request</i>	Consumption:	T01 = 6.8 Watt T03 = 18 Watt
Installation:	Preferable with actuator upright	Protection class:	IP 65 acc. to DIN 60529
Pressure:	0.3 - 20 bar (see table page 2)	Duty factor:	100% ED - VDE 0580
Medium:	Clean, neutral, liquid or gaseous	Connection type:	Plug
Viscosity:	22 mm <sup>2</sup> /s	Function:	NC NO
Temperature range:	Medium: -10 °C up to +140 °C Ambient: -10 °C up to +50 °C		
Body material	Brass 2.0402 Stainless steel 1.4581 (AISI 316Ti)	Certificates:	
Metallic inner parts:	Brass and stainless steel	Ex-proof:	-
Sealing:	FKM, EPDM		

## ORDERING SYSTEM

M-ET	2	03	G	D	13.5	A	C	T01	
Type	Control type	Code	Connection type	Connection size	Nominal diameter mm	Body material	Sealing material	Actuator type	Option
	2 pilot operated		G BSP N NPT	B 1/4 C 3/8 D 1/2 E 3/4 F 1 G 1 1/4 H 1 1/2 I 2		A Brass C AISI316	B FKM C EPDM	T +140°C	

Standard NC type	Seat $\varnothing$ mm	Kv-value m <sup>3</sup> /h	max. pressure NC		max. pressure NO
			T01	T03	T03
M-ET 203 GB	13.5	1.6	0.3-8	0.3-20	0.3-16
M-ET 203 GC	13.5	3.3	0.3-8	0.3-20	0.3-16
M-ET 203 GD	13.5	3.8	0.3-8	0.3-20	0.3-16
M-ET 203 GE	27.5	11.0	0.3-8	0.3-20	0.3-16
M-ET 203 GF	27.5	13.0	0.3-8	0.3-20	0.3-16
M-ET 203 GG	40.0	30.0	-	0.3-16	0.3-10
M-ET 203 GH	40.0	32.0	-	0.3-16	0.3-10
M-ET 203 GI	50.0	45.0	-	0.3-16	0.3-10

## Valve design

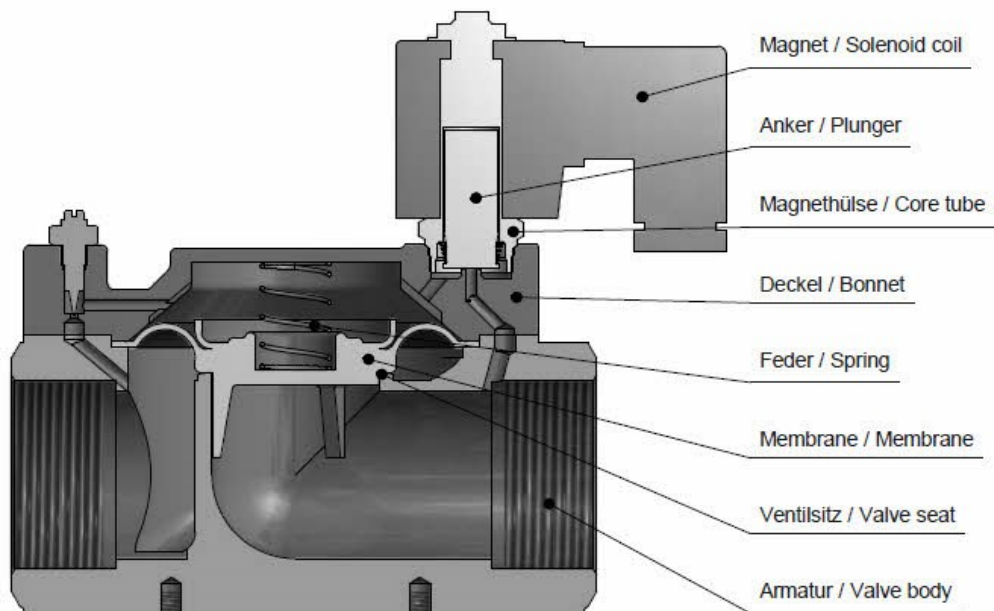

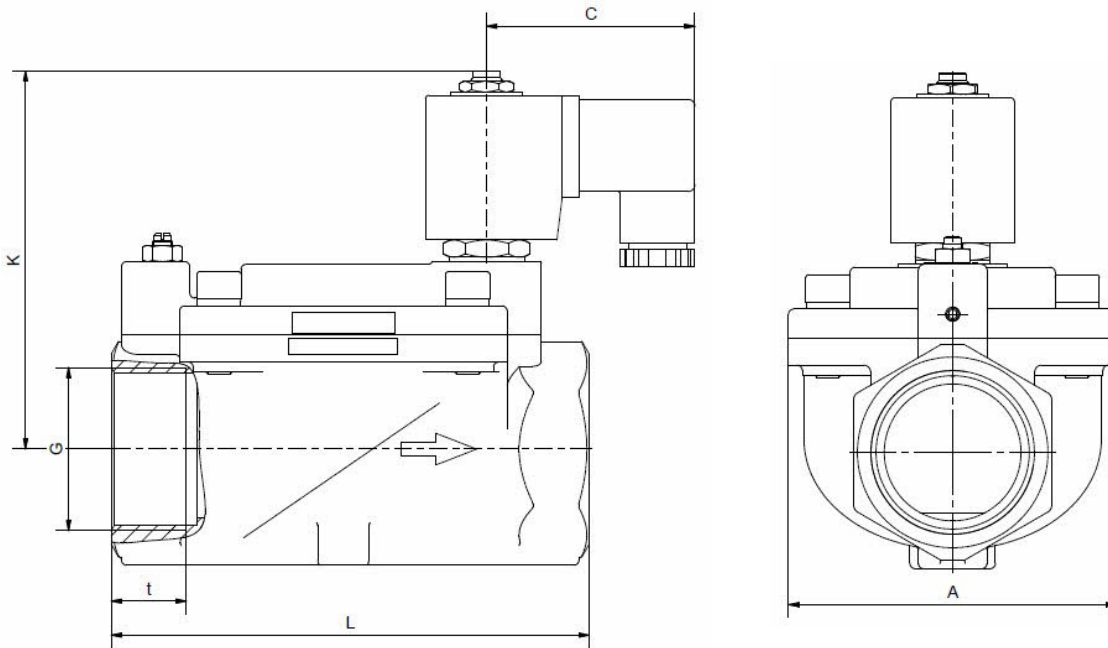

Coil	T01				
Type	M ET 203				
	GB	GC	GD	GE	GF
G	1/4	3/8	1/2	3/4	1
A	48	48	48	70	70
C	51	51	51	51	51
K	75	75	75	87	87
L	67	67	67	96	96
t	12	12	12	16	16
kg	0.9	0.9	0.8	1.7	1.5

Coil	T03							
Type	M ET 203							
	GB	GC	GD	GE	GF	GG	GH	GI
G	1/4	3/8	1/2	3/4	1	1 1/4	1 1/2	2
A	48	48	48	70	70	96	96	112
C	61	61	61	61	61	61	61	61
K	90	90	90	102	102	110	110	120
L	67	67	67	96	96	140	140	168
t	12	12	12	16	16	22	22	22
kg	0.9	0.9	0.8	1.7	1.5	3.1	2.9	4.0

- The GVT logo is a registered trademark.
- Note: All texts and images are the property of GVT and must not be replicated or modified, not even in part, without written approval.
- Original products may differ from the product images shown, due to different materials and the like.
- Subject to error and changes.