

2/2-way solenoid valve - valve normally closed (NC)
- valve normally open (NO)

Solenoid valve for neutral, gaseous and liquid media

- Best use for low pressure ranges
- No pressure difference necessary
- High life time
- Reliable and sturdy sealing elements
- Long-term availability of spare parts
- High-quality materials

TECHNICAL SPECIFICATIONS

Type of control: Direct operated,
no pressure difference necessary

Design: Piston design

Connection: Flanges DN15 - DN100
EN 1092-1 Form B1/B2
Further connections on request

Installation: Actuator upright

Pressure: 0 - 1.4 bar (see table page 2)

Medium: Clean, neutral, liquid or gaseous

Viscosity: 22 mm²/s

Temperature range: Medium: -10 °C up to +80 °C
Ambient: -10 °C up to +50 °C

Body material: Cast iron EN-GJL-250
Cast steel GP240 GH

Metallic inner parts: Brass and stainless steel

Sealing: NBR, FKM, EPDM, PTFE

Supply voltage: AC 50/60Hz 24V, 110V, 230V
DC 0Hz 12V, 24V

Voltage tolerance: -10% / +10%

Consumption:	A05 = 24 Watt	E05 = 24 Watt
	A06 = 30 Watt	E06 = 24 Watt
	A07 = 46 Watt	E07 = 30 Watt
	A08 = 100 Watt	E08 = 47 Watt
	A09 = 150 Watt	E09 = 75 Watt

Protection class: IP 65 acc. to DIN 60529

Duty factor: 100% ED - VDE 0580

Connection type: Plug, Terminal box

Funktion:



Certificates:



Ex-proof: acc. to directive 2014/34/EG (ATEX)

ORDERING SYSTEM

M-PS	1	06	D	O	50.0	E	A	A07	NO
Type	Control type	Code	Connection type	Connection size	Nominal diameter mm	Body material	Sealing material	Actuator type	Option
	1 direct operated		D PN16	J DN15		E EN-GJL-250	A NBR	A standard	
			X PN40	K DN20		F GP240 GH	B FKM	E ex.-proof	
			A ANSI150	L DN25			C EPDM		
			Y ANSI300	M DN32			D PTFE		
				N DN40					
				O DN50					
				P DN65					
				Q DN80					
				R DN100					

Standard NC type	Seat ϕ mm	Kv-value m ³ /h	max. pressure					max. pressure ATEX				
			A05	A06	A07	A08	A09	E05	E06	E07	E08	E09
M-PS 106 DJ	15	7.0	0-0.4	0-1.4	-	-	-	0-0.4	0-0.6	-	-	-
M-PS 106 DK	20	9.0	0-0.4	0-1.0	-	-	-	0-0.4	0-0.4	-	-	-
M-PS 106 DL	25	12.0	-	0-0.4	0-1.0	-	-	-	0-0.2	0-0.6	-	-
M-PS 106 DM	32	18.0	-	0-0.25	0-0.6	-	-	-	0-0.06	0-0.3	-	-
M-PS 106 DN	40	26.0	-	0-0.1	0-0.25	-	-	-	-	0-0.1	-	-
M-PS 106 DO	50	38.0	-	-	0-0.1	0-0.3	-	-	-	0-0.07	0-0.2	-
M-PS 106 DP	65	75.0	-	-	-	0-0.15	0-0.4	-	-	-	-	0-0.1
M-PS 106 DQ	80	89.0	-	-	-	0-0.1	0-0.3	-	-	-	-	0-0.1
M-PS 106 DR	100	125.0	-	-	-	-	0-0.15	-	-	-	-	0-0.1

Valve design

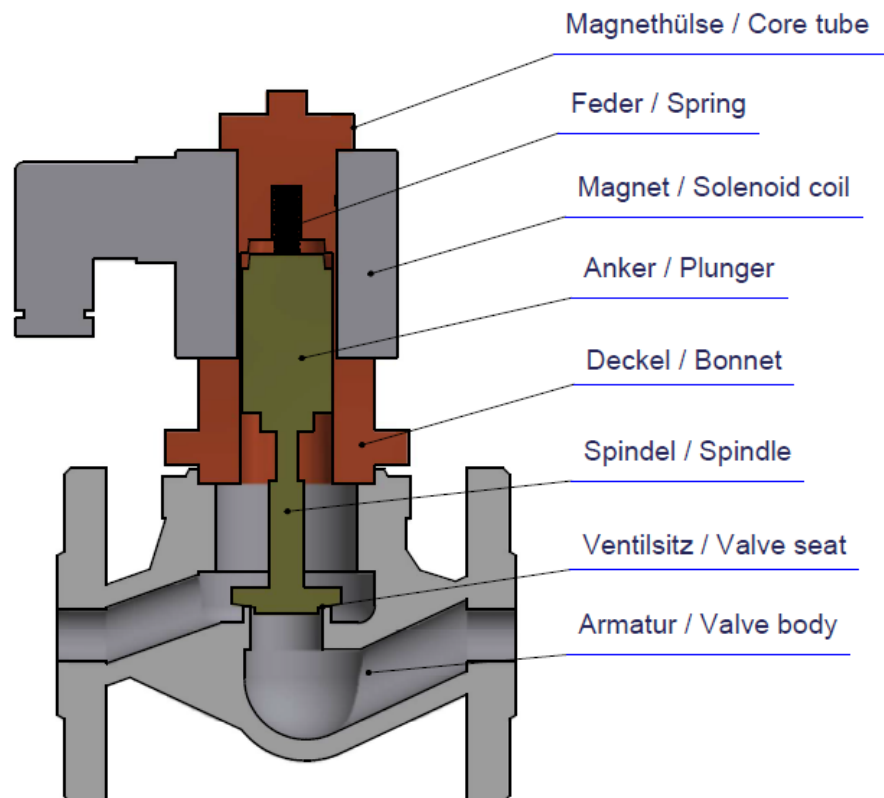

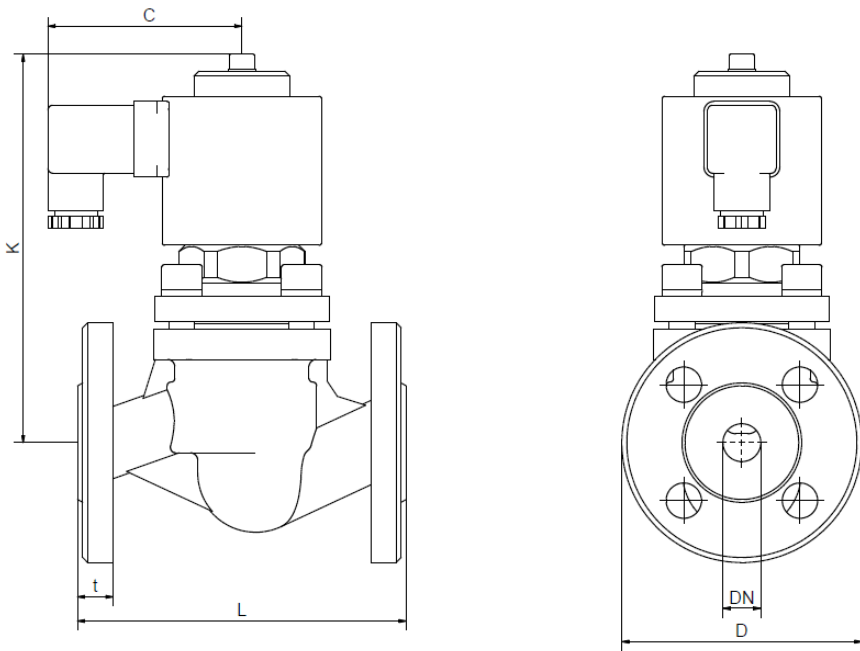

Coil	A05 / E05		A06 / E06				A06 / E06		
	M-PS 106		M-PS 106				M-PS 106		
	DJ	DK	DJ	DK	DL	DM	DN	DL	DM
DN	15	20	15	20	25	32	40	25	32
C	70	70	77	77	77	77	77	93	93
D	95	105	95	105	115	140	150	115	140
K	129	129	154	154	163	161	168	190	180
L	130	150	130	150	160	180	200	160	180
t	14.5	16.5	14.5	16.5	16	16	19	16	16
kg	3.6	3.9	4.1	4.7	5.9	6.7	9.4	7.9	8.2

Coil	A05 / E05		A06 / E06			A06 / E06		
	M-PS 106		M-PS 106			M-PS 106		
	DN	DO	DO	DP	DQ	DP	DQ	DR
DN	40	50	50	65	80	65	80	100
C	93	93	107	107	107	127	127	127
D	150	165	165	185	200	185	200	220
K	194	198	242	256	239	339	329	357
L	200	230	230	290	310	290	310	350
t	19	20.5	20.5	20.5	22	20.5	22	24.5
kg	10.7	12.7	16.4	20.6	25.4	32.1	37.0	45.3

- The GVT logo is a registered trademark.
- Note: All texts and images are the property of GVT and must not be replicated or modified, not even in part, without written approval.
- Original products may differ from the product images shown, due to different materials and the like.
- Subject to error and changes.