

Technical Data Sheet M-ET 302

GVT.

2/2-way solenoid valve - valve normally closed (NC)
- valve normally open (NO)

Solenoid valve for extended temperature range

- For high temperature applications **+200°C**
- No pressure difference necessary
- High life time
- Reliable and sturdy sealing elements
- Long-term availability of spare parts
- High-quality materials

TECHNICAL SPECIFICATIONS

Type of control: Force-pilot operated, no pressure difference necessary

Design: Piston design

Connection: Flanges DN15 - DN200
EN 1092-1 Form B1/B2
Further connections on request

Installation: Actuator upright

Pressure: 0 - 40 bar (see table page 2)

Medium: Clean, neutral, liquid or gaseous

Viscosity: 22 mm²/s

Temperature range: Medium: -40 °C up to +200 °C
Ambient: -40 °C up to +50 °C

Body material: Spheroidal cast EN-GJS-400-18-LT
Cast iron EN-GJL-250
Cast steel GP240 GH
Stainless steel 1.4581 (AISI 316Ti)

Metallic inner parts: Brass and stainless steel

Sealing: PTFE

Supply voltage: AC 50/60Hz 24V, 110V, 230V
DC 0Hz 12V, 24V

Voltage tolerance: -10% / +10%

Consumption: T05 = 18 Watt T09 = 80 Watt
T06 = 21 Watt T10 = 180 Watt
T07 = 26 Watt
T08 = 60 Watt

Protection class: IP 65 acc. to DIN 60529

Duty factor: 100% ED - VDE 0580

Connection type: Terminal box

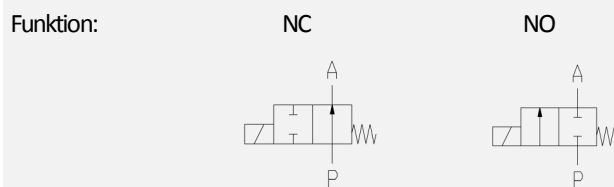

Certificates:



Ex-proof: -

ORDERING SYSTEM

M-ET	3	02	D	O	50.0	E	D	T07	
Type	Control type	Code	Connection type	Connection size	Nominal diameter mm	Body material	Sealing material	Actuator type	Option
	3 force-pilot oper.		D PN16	J DN15		C AISI316Ti	D PTFE	T Temperature design	
			X PN40	K DN20		E EN-GJL-250			
			A ANSI150	L DN25		F GP240 GH			
			Y ANSI300	M DN32		G EN-GJS-400-18-LT			
				N DN40					
				O DN50					
				P DN65	S DN125				
				Q DN80	T DN150				
				R DN100	U DN150				

Standard NC type	Seat \varnothing mm	Kv-value m^3/h	max. pressure					
			T05	T06	T07	T08	T09	T10
M-ET 301 DJ	15	5.0	0-20	0-40	-	-	-	-
M-ET 301 DK	20	11.0	0-13	0-25	0-40	-	-	-
M-ET 301 DL	25	13.0	0-13	0-25	0-40	-	-	-
M-ET 301 DM	32	28.0	-	0-12	0-20	0-40	-	-
M-ET 301 DN	40	30.0	-	0-12	0-20	0-40	-	-
M-ET 301 DO	50	46.0	-	-	0-6	0-25	0-40	-
M-ET 301 DP	65	75.0	-	-	-	0-25	0-40	-
M-ET 301 DQ	80	97.0	-	-	-	0-20	0-40	-
M-ET 301 DR	100	143.0	-	-	-	0-12	0-20	-
M-ET 301 DS	125	240.0	-	-	-	-	0-9	0-25
M-ET 301 DT	150	370.0	-	-	-	-	0-4	0-25
M-ET 301 DU	200	625.0	-	-	-	-	-	0-20

The flow rate mentioned in the table applies to the strongest coil.

Max. pressure 0-13 bar with EN-GJL-250 body PN16

Valve design

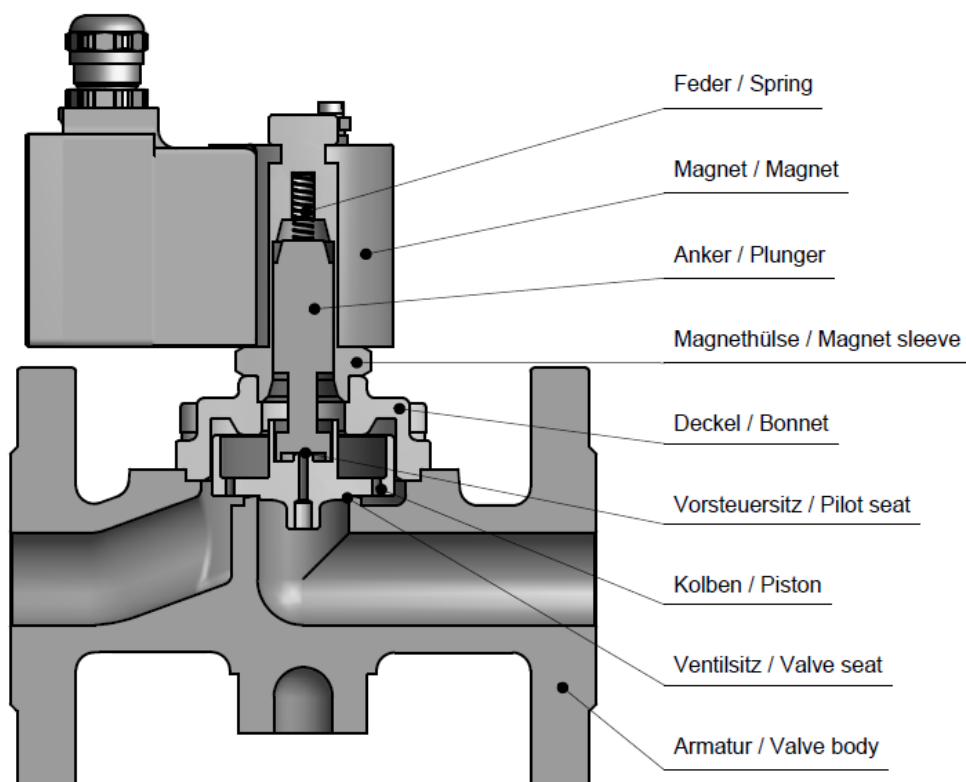

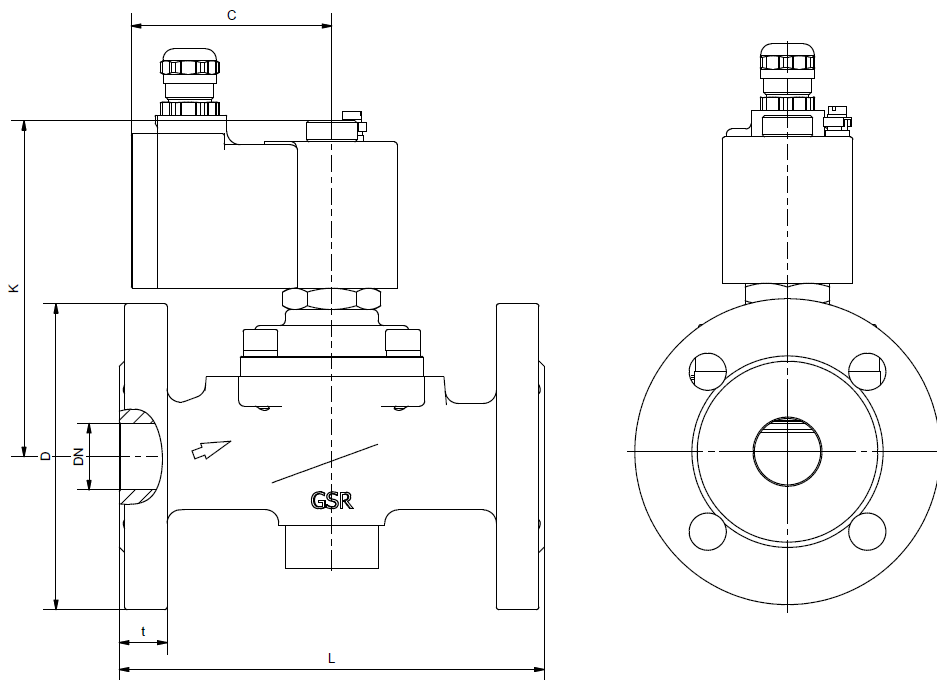

Coil	T05			T06					T07				
Type	M-ET 302			M-ET 302					M-ET 302				
	DJ	DK	DL	DJ	DK	DL	DM	DN	DK	DL	DM	DN	DO
DN	15	20	25	15	20	25	32	40	20	25	32	40	50
C	76	76	76	83	83	83	83	83	93	93	93	93	93
D	95	105	115	95	105	115	140	150	105	115	140	150	165
K	115	130	150	150	145	145	160	160	185	190	200	200	200
L	130	150	160	130	150	160	180	200	150	160	180	200	230
t	14	16	16	14	16	16	16	16	16	16	16	16	18
kg	3.5	4.5	5.5	3.0	5.0	5.5	8.0	8.5	7.5	7.5	10.5	11.0	14.0

Coil	T08						T09						T10		
Type	M-ET 302						M-ET 302						M-ET 302		
	DM	DN	DO	DP	DQ	DR	DO	DP	DQ	DR	DS	DT	DS	DT	DU
DN	32	40	50	65	80	100	50	65	80	100	125	150	125	150	200
C	107	107	107	107	107	107	127	120	120	120	120	120	160	160	160
D	140	150	165	185	200	220	165	185	200	235	270	285	250	285	340
K	230	230	240	295	295	360	319	390	390	380	350	420	580	615	680
L	180	200	230	290	310	350	230	290	310	350	400	480	400	480	600
t	16	16	18	18	20	20	18	18	20	20	26	26	26	26	30
kg	15.0	15.5	18.5	29.0	39.5	55.0	29.6	45.0	53.5	64.5	72.5	84.0	133.5	157.0	208.0

- The GVT logo is a registered trademark.
- Note: All texts and images are the property of GVT and must not be replicated or modified, not even in part, without written approval.
- Original products may differ from the product images shown, due to different materials and the like.
- Subject to error and changes.