

2/2-way solenoid valve - valve normally closed (NC)
- valve normally open (NO)



Solenoid valve for high temperature application

- For temperatures **up to +140°C**
- No pressure difference necessary
- High life time
- Reliable and sturdy sealing elements
- Long-term availability of spare parts
- High-quality materials

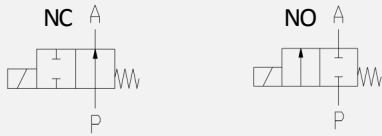

TECHNICAL SPECIFICATIONS

Type of control:	Force-pilot operated, no pressure difference necessary
Design:	Diaphragm design
Connection:	Flanged acc. to EN 1092-1 Form B1/B2 <i>Further connections on request</i>
Installation:	Actuator upright
Pressure:	0 - 16 bar (see table page 2)
Medium:	Clean, neutral, liquid or gaseous
Viscosity:	22 mm ² /s
Temperature range:	Medium: -10 °C up to +140 °C Ambient: -10 °C up to +50 °C
Body material	Cast Iron EN-GJL-250 (DN20-DN50) Cast steel GP240 GH (DN15-DN50) Stainless steel 1.4581 (DN15-DN50)
Metallic inner parts:	Brass and stainless steel
Sealing:	FKM, EPDM

Supply voltage:	AC 50/60Hz 24V, 110V, 230V DC 0Hz 12V, 24V
Voltage tolerance:	-10% / +10%
Consumption:	T03 = 18,5 Watt T05 = 18 Watt T06 = 21 Watt T07 = 44 Watt T08 = 60 Watt
Protection class:	IP 65 acc. to DIN 60529
Duty factor:	100% ED - VDE 0580
Connection type:	Plug, Terminal box
Function:	
Certificates:	
Ex-proof:	acc. to directive 2014/34/EG (ATEX)

ORDERING SYSTEM

M-ET	3	07	D	L	25.0	E	C	T06	HA
Type	Control type	Code	Connection type	Connection size	Nominal diameter mm	Body material	Sealing material	Actuator type	Option
	3 force-pilot oper.		D PN16 X PN40 A ANSI150 Y ANSI300	J DN15 K DN20 L DN25 M DN32 N DN40 O DN50		C AISI316L E EN-GJL-250 F GP240 GH	B FKM C EPDM	T Temp.coil	

Standard NC type	Seat \varnothing mm	Kv-value m^3/h	max. pressure NC				
			T03	T05	T06	T07	T08
M-ET 307 DJ	15	3.9	0-10	0-16	-	-	-
M-ET 307 DK	20	10.8	0-8	0-12	0-16	-	-
M-ET 307 DL	25	13.0	0-8	0-12	0-16	-	-
M-ET 307 DM	32	30.0	-	-	0-3	0-8	0-16
M-ET 307 DN	40	32.0	-	-	0-3	0-8	0-16
M-ET 307 DO	50	45.0	-	-	-	0-6	0-16

Standard NC type	Seat \varnothing mm	Kv-value m^3/h	max. pressure NO				
			T03-NO	T05-NO	T06-NO	T07-NO	T08-NO
M-ET 307 DJ	15	3.9	-	0-16	-	-	-
M-ET 307 DK	20	10.8	-	0-12	0-10	0-16	-
M-ET 307 DL	25	13.0	-	0-12	0-10	0-16	-
M-ET 307 DM	32	30.0	-	-	0-3	0-8	0-16
M-ET 307 DN	40	32.0	-	-	0-3	0-8	0-16
M-ET 307 DO	50	45.0	-	-	-	0-6	0-16

Valve design

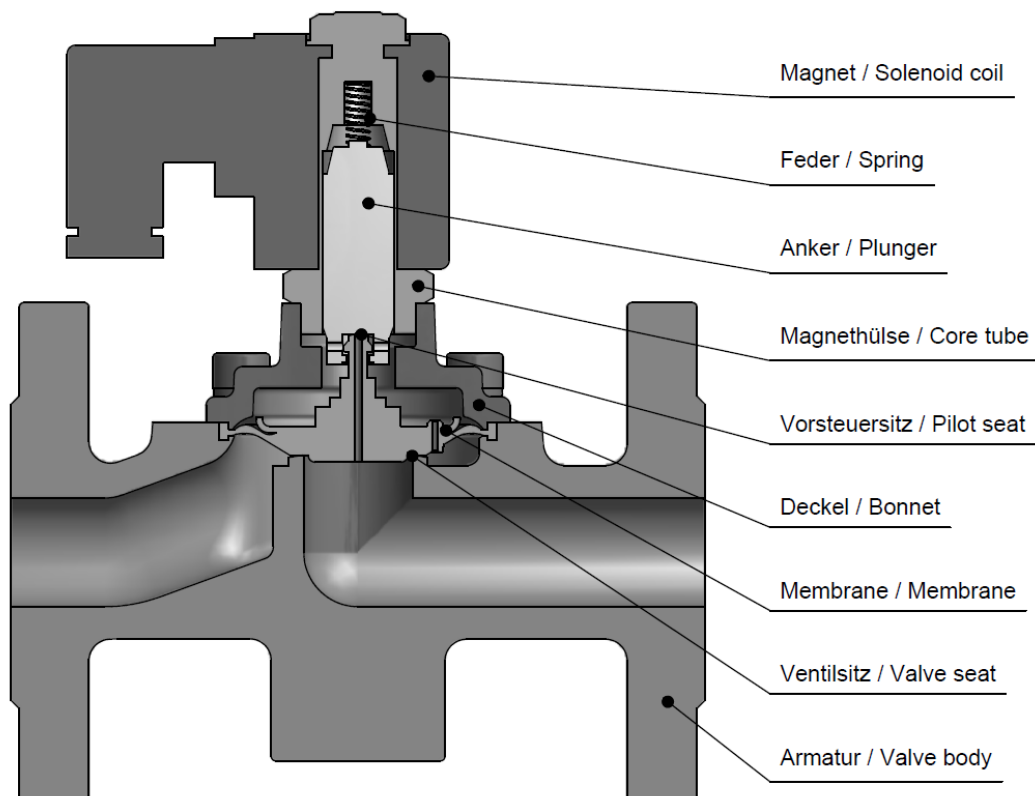

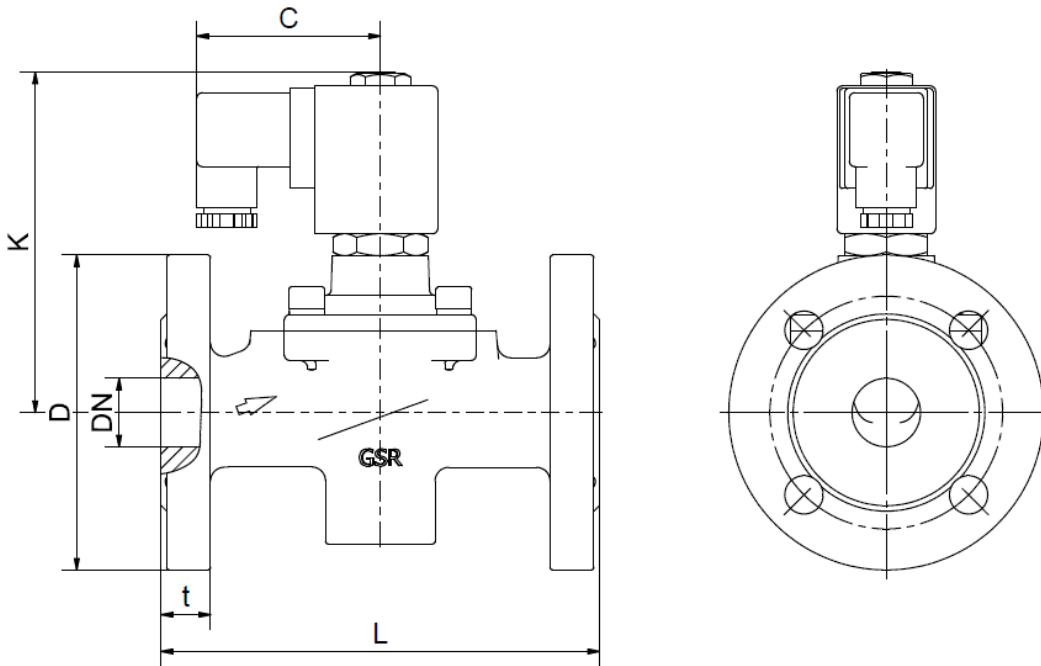

Coil	T03			T05			T06	
Type	M-DS 302			M-DS 302			M-DS 302	
	DJ	DK	DL	DJ	DK	DL	DK	DL
DN	15	20	25	15	20	25	20	25
C	61	61	61	76	76	76	84	84
D	95	105	115	95	105	115	105	115
K	94 (86)	100 (96)	100 (96)	114 (108)	129 (124)	129 (124)	172 (167)	172 (167)
L	130	150	160	130	150	160	150	160
t	16	18	18	16	18	18	18	18
kg	2.8	3.9	4.5	3.6	4.7	5.3	5.3	5.8

Values in brackets refer to the stainless steel version

Coil	T06		T07			T08		
Type	M-DS 302		M-DS 302			M-DS 302		
	DM	DN	DM	DN	DO	DM	DN	DO
DN	32	40	32	40	50	32	40	50
C	84	84	93	93	93	107	107	107
D	140	150	140	150	165	140	150	165
K	184 (172)	184 (172)	209 (198)	209 (198)	218 (205)	254 (242)	254 (242)	264 (251)
L	180	200	180	200	230	180	200	230
t	18	18	18	18	20	18	18	20
kg	8.9	11.9	10.2	10.7	13.6	13.4	14.0	17.5

Values in brackets refer to the stainless steel version

- The GVT logo is a registered trademark.
- Note: All texts and images are the property of GVT and must not be replicated or modified, not even in part, without written approval.
- Original products may differ from the product images shown, due to different materials and the like.
- Subject to error and changes.