



Technical Data Sheet M-ET 304

GVT.

2/2-way solenoid valve - valve normally closed (NC)
- valve normally open (NO)

Solenoid valve for high temperature applications

- For high temperature applications **+250°C**
- No pressure difference necessary
- High life time
- Reliable and sturdy sealing elements
- Long-term availability of spare parts
- High-quality materials

TECHNICAL SPECIFICATIONS

Type of control: Force-pilot operated,
no pressure difference necessary

Design: Piston design

Connection: Flanged DN15 - DN100
acc. to EN 1092-1 Form B1/B2

Installation: Actuator upright

Pressure: 0 - 40 bar (see table page 2)

Medium: Clean, neutral, liquid or gaseous

Viscosity: 22 mm²/s

Temperature range: Medium: -40 °C up to +250 °C
Ambient: -40 °C up to +50 °C

Body material: Cast steel GP240 GH
Stainless steel 1.4581 (AISI 316Ti)

Metallic inner parts: Stainless steel

Sealing: PEEK

Supply voltage: AC 50/60Hz 24V, 110V, 230V
DC 0Hz 12V, 24V

Voltage tolerance: -10% / +10%

Consumption: T06 = 21 Watt T10 = 180 Watt
T07 = 26 Watt
T08 = 60 Watt
T09 = 80 Watt

Protection class: IP 65 acc. to DIN 60529

Duty factor: 100% ED - VDE 0580

Connection type: Terminal box

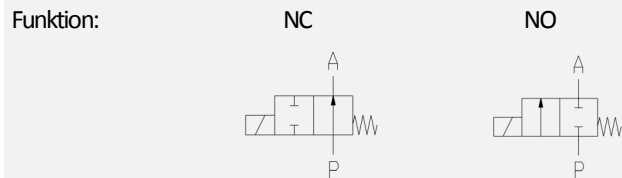

Certificates:



Ex-proof: -

ORDERING SYSTEM

M-ET	3	04	X	O	50.0	C	E	T08	NO
Type	Control type	Code	Connection type	Connection size	Nominal diameter mm	Body material	Sealing material	Actuator type	Option
	3 force-pilot oper.		X PN40 Y ANSI300	J DN15 K DN20 L DN25 M DN32 N DN40 O DN50 P DN65 Q DN80 R DN100		C AISI316 F GP240GH	E PEEK	T Temperature version	

Standard NC type	Seat ø mm	Kv-value m ³ /h	max. pressure				
			T06	T07	T08	T09	T10
M-ET 304 XJ	15	5.0	0-10	0-32*	-	-	-
M-ET 304 XK	20	11.0	0-6	0-25	-	-	-
M-ET 304 XL	25	13.0	0-6	0-25	-	-	-
M-ET 304 XM	32	24.0	-	0-6	0-25	-	-
M-ET 304 XN	40	27.0	-	0-6	0-25	-	-
M-ET 304 XO	50	42.0	-	0-6	0-25	-	-
M-ET 304 XP	65	75.0	-	-	0-25	0-32*	-
M-ET 304 XQ	80	97.0	-	-	0-20	0-32*	-
M-ET 304 XR	100	143.0	-	-	-	0-20	0-32*

* max. 40 bar with special housing on request

Valve design

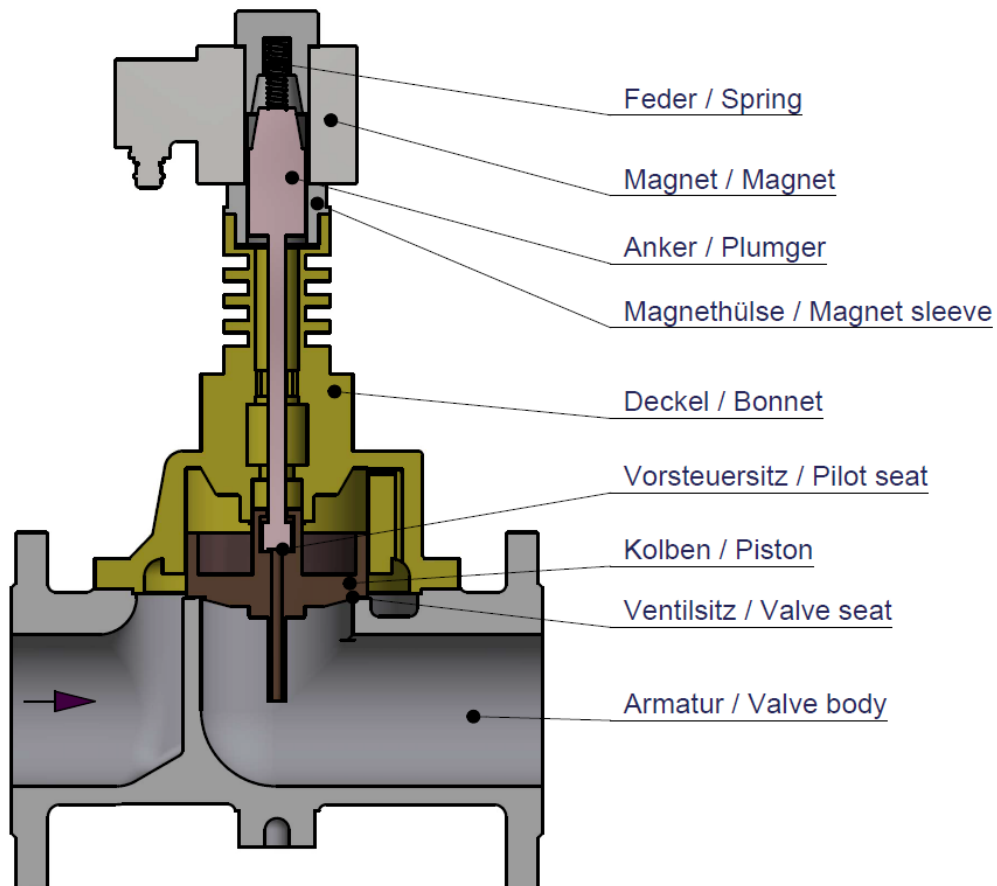

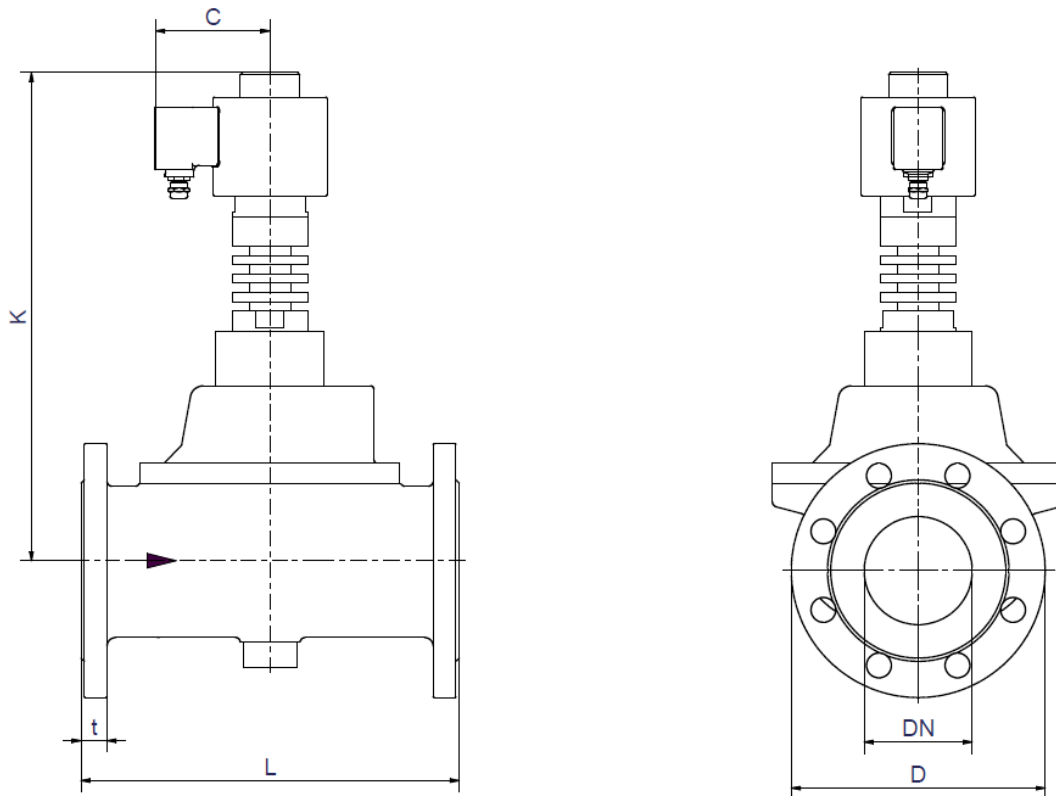

Coil	T06			T07					
Type	M-ET 304			M-ET 304					
	XJ	XK	XL	XJ	XK	XL	XM	XN	XO
DN	15	20	25	15	20	25	32	40	50
C	83	83	83	93	93	93	93	93	93
D	95	105	115	95	105	115	140	150	165
K	256	250	265	295	298	283	299	299	299
L	130	150	160	130	150	160	180	200	230
t	16	18	18	16	18	18	18	18	20
kg	3.9	5.5	5.8	7.5	7.7	6.8	9.6	10.1	12.6

Coil	T08						T09			T10
Type	M-ET 304						M-ET 304			M-ET 304
	XM	XN	XO	XP	XQ	XR	XP	XQ	XR	XR
DN	32	40	50	65	80	100	65	80	100	100
C	107	107	107	107	107	107	120	120	120	159
D	140	150	165	185	200	235	185	200	235	235
K	335	335	358	400	400	465	495	505	495	on req.
L	180	200	230	290	310	350	290	310	350	350
t	18	18	20	22	24	24	22	24	24	24
kg	11.2	11.4	14.9	32.8	40.7	56.2	44.7	68.5	63.9	on req.

- The GVT logo is a registered trademark.
- Note: All texts and images are the property of GVT and must not be replicated or modified, not even in part, without written approval.
- Original products may differ from the product images shown, due to different materials and the like.
- Subject to error and changes.