







2/2-way solenoid valve - valve normally closed (NC)
- valve normally open (NO)

Solenoid valve for high pressure applications

- For high pressure applications up to **150 bar**
- No pressure difference necessary
- High life time
- Reliable and sturdy sealing elements
- Long-term availability of spare parts
- High-quality materials

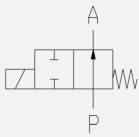
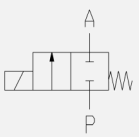
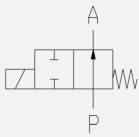
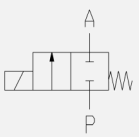
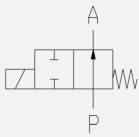
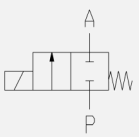
TECHNICAL SPECIFICATIONS

Type of control:	Direct operated, no pressure difference necessary
Design:	Piston design
Connection:	Threaded G 1/4 DIN ISO 228 (BSP) <i>Further connections on request</i>
Installation:	Preferable with actuator upright
Pressure:	0 - 150 bar (see table page 2)
Medium:	Clean, neutral, liquid or gaseous
Viscosity:	22 mm ² /s
Temperature range:	Medium: -40 °C up to +80 °C Ambient: -40 °C up to +50 °C
Body material	Brass 2.0401 / 2.0402 Stainless steel 1.4305 (AISI 303) Stainless steel 1.4571 (AISI 316Ti)
Metallic inner parts:	Brass and stainless steel
Sealing:	PTFE

Supply voltage:	AC 50/60Hz 24V, 110V, 230V DC 0Hz 12V, 24V				
Voltage tolerance:	-10% / +10%				
Consumption:	A02 = 11 Watt E02 = 10 Watt A03 = 18,5 Watt				
Protection class:	IP 65 acc. to DIN 60529				
Duty factor:	100% ED - VDE 0580				
Connection type:	Plug				
Function:	<table border="0" style="width: 100%;"> <tr> <td style="text-align: center;">NC</td> <td style="text-align: center;">NO</td> </tr> <tr> <td style="text-align: center;">  </td> <td style="text-align: center;">  </td> </tr> </table>	NC	NO		
NC	NO				
					
Certificates:	  				
Ex-proof:	acc. to directive 2014/34/EG (ATEX)				

ORDERING SYSTEM

M-PS	1	01	G	B	1.0	A	B	A03	S
Type	Control type	Code	Connection type	Connection size	Nominal diameter mm	Body material	Sealing material	Actuator type	Option
	1 direct operated		G BSP N NPT	B 1/4		A Brass C AISI316	D PTFE	A standard E ex.-proof	S special tube

Standard type	Seat \varnothing mm	Kv-value m ³ /h	max. pressure for coils					
			A02		A03		E02	
			NC	NO	NC	NO	NC	NO
M-PS 101 GB	1.0	0.06	0-150	-	0-150	0-150	0-150	0-150
M-PS 101 GB	1.2	0.08	0-90	-	0-130	0-100	0-60	0-90
M-PS 101 GB	1.5	0.09	-	-	0-120	-	-	-

Dimensions

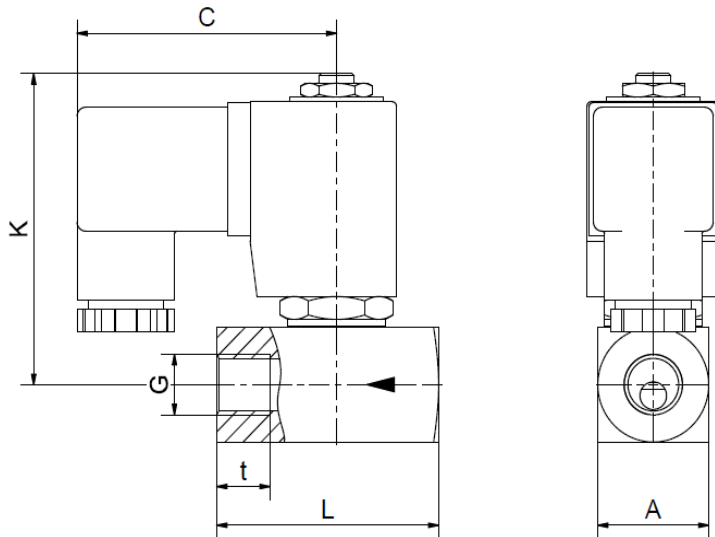

Coil	A02	A03 / E02*
G	1/4	1/4
A	30	30
C	59	61
K	75	75
L	50	50
t	12	12
kg	0.35	0.35

* different dimension „C“ at ATEX coils

- The GVT logo is a registered trademark.
- Note: All texts and images are the property of GVT and must not be replicated or modified, not even in part, without written approval.
- Original products may differ from the product images shown, due to different materials and the like.
- Subject to error and changes.